

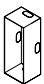



Kmuun DCS

Intelligent Entry System User Manual

v 0.9.3

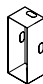
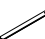
Indoor unit  Width: 86 Height: 172 Thickness: 14	Indoor unit embedded box  Width: 68 Height: 172 Depth: 60 (mm)	Wall-embedded outdoor unit  Width: 80 Height: 184 Thickness: 3.5-23.5	OU Mounting box  Width: 74 Height: 178 Depth: 19	OU Embedded box  Width: 68 Height: 172 Depth: 60 (mm)	Latch Removal 
Material <ul style="list-style-type: none"> Anodized aluminum alloy Tempered glass 	Keypad <ul style="list-style-type: none"> 6 - 10 digits Passcode 20-digit intelligent false code recognition Independent dynamic backlight RFID card Induction 	Facial Recognition <ul style="list-style-type: none"> Recognition distance: 30 - 120 cm Recognition height: 1 - 2.2 m FRR: < 0.01% FAR: < 0.00001% Verification speed: < 350 ms 	Power <ul style="list-style-type: none"> 12 ~ 24 V DC Operating Environment <ul style="list-style-type: none"> RH(Non-cond) 20% ~ 93% Temp: -10°C ~ 55°C Optional low-temperature heating module 	APP Support <ul style="list-style-type: none"> Kmuun APP  <ul style="list-style-type: none"> Video intercom Remote unlocking Event Log Message notifications Device sharing 	Packing List <ul style="list-style-type: none"> Indoor Unit Outdoor Unit Accessories Card User Manual
Installation <ul style="list-style-type: none"> Long-distance wall mounting Ultra-thin embedded design 	Fingerprint <ul style="list-style-type: none"> Resolution: 500 DPI FRR: ≤0.15% FAR: ≤0.00004% Automatic fingerprint intelligent update 	Peephole Camera <ul style="list-style-type: none"> Night vision with LED fill light Wide-angle lens Resolution: 1280 x 720 	Voice Guidance: <ul style="list-style-type: none"> Chinese English 		Firmware <ul style="list-style-type: none"> DCS-0330-092
Storage <ul style="list-style-type: none"> 100 access keys 					

安装示意图

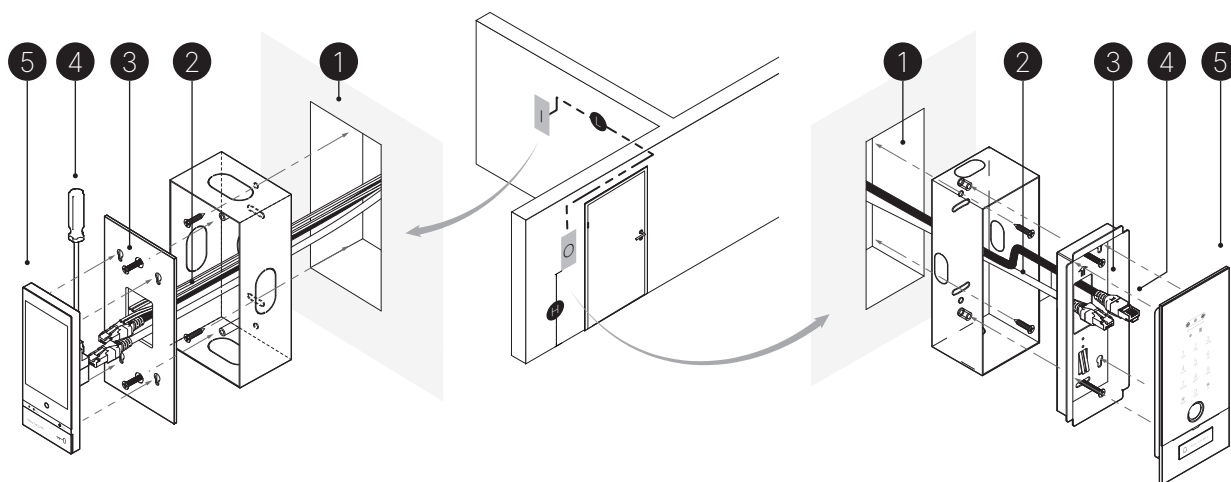

① After positioning the indoor and outdoor units, pre-install the conduit and secure the junction box with screws for later installation.

**Installation requirements:
L (indoor-outdoor): <4m
H (outdoor unit): 1.35-1.45m**

② Installation Wiring: Thread the following required cables through the pre-installed conduit:

Inter-unit connection cable Cat6a double-shielded Ethernet cable × 2 colors

12~24V DC ** Power cable RVV2 x 2.0 mm² 2-core signal cable

Lock control cable RVV2 x 2.0 mm² 2-core signal cable

* - Terminate the Ethernet cable with Cat6a RJ45 connectors per national standards after threading.

** - For long-distance power supply, use a 24V DC power source.

③ Fix the "indoor unit mounting" to the "indoor unit embedded box" and the "OU Mounting box" to the "OU Embedded box" respectively, using four M4 × 40 flat-head screws each.

④ Connect pre-run inter-unit, power, and lock control cables between indoor/outdoor units per wiring diagram.

① Indoor unit ② outdoor unit:

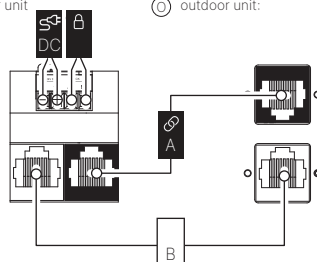

!! Connect the product without power.
Wire correctly per the diagram.
After setup, power on. If malfunction occurs, disconnect power and check wiring. If unresolved, contact technical support.

⑤ ***If power-on test passes, mount:
Indoor unit on mounting bracket
Outdoor unit on base installation box***

⑥ Secure the indoor unit

⑦ Remove/detach the outdoor unit

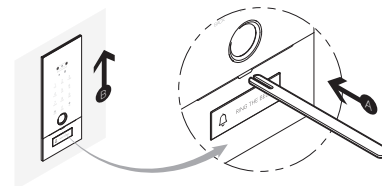

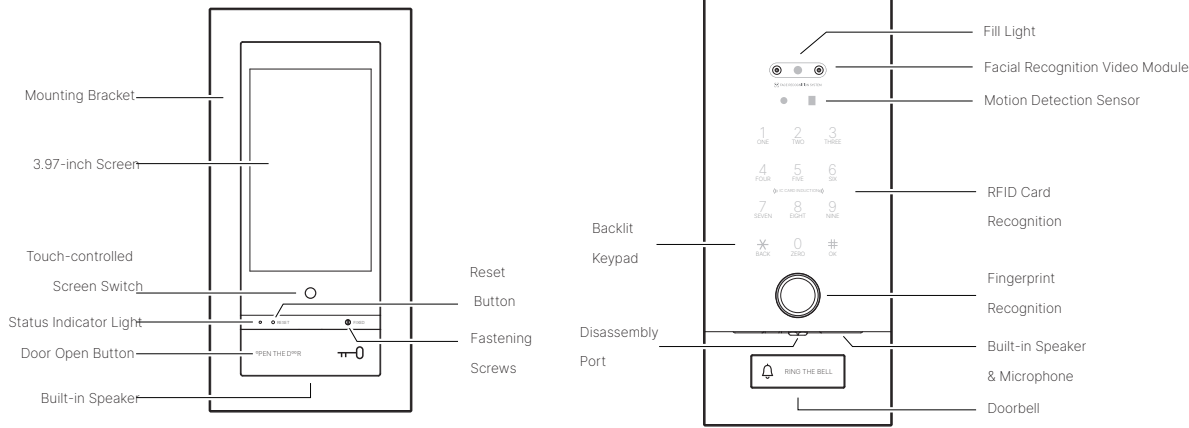

Basic Local Configuration Process

Short-press indoor unit's "Config Button" with pin tool, or enter *# on outdoor keypad.Mode Access:Factory Mode: Voice-guided config menu (direct access)Normal Mode: Admin authentication required.Voice Menu:Announces 6 config options (audio navigation).Current local config support: [list/description]

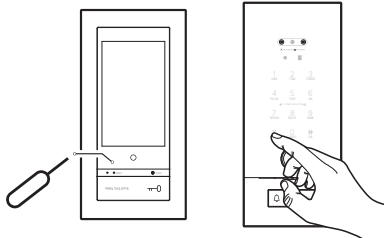

1 Create New User 2 Delete User 3 System Settings 6 Factory Reset

1 Create New User

Operation Successful, User ID 00
Factory Mode Initial Configuration:The first-time setup in factory mode will activate Administrator Configuration Mode, allowing configuration of up to 10 administrator access keys.

Please enter user ID
Enter new or existing user number (00-99),Press the # (hash) key to confirm.Proceed to credential configuration.00 → Administrator account.01-99 → Standard user accounts

User ## please enter your access key 1 Register fingerprint, code, or card, 2 Facial Registration

1 Register fingerprint, code, or card

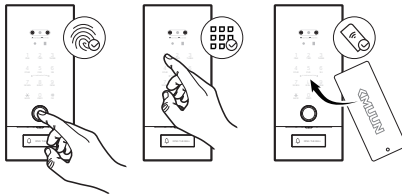

Place your finger on the outdoor unit's fingerprint scanner.Verification Prompts:Press finger again(repeats until sufficient data captured)Enrollment successful(final confirmation).Error Conditions:Incorrect pressure → Scan failed - reposition finger.Early removal → Process interrupted.

Please enter a 6 to 10-digit password on the keypad and input it twice as prompted by the voice. If the voice announcement says "Operation successful," it means the RFID card has been successfully registered.- Passwords that do not meet the digit requirement or inconsistent inputs between the two attempts will result in an "Operation failed" prompt.Repeated passwords will trigger a "Duplicate password" prompt.

Hold your RFID card near the outdoor unit's keypad area. System Feedback Success Card registered successfully.Error (duplicate): Duplicate card detected.

2 Facial Registration

Please look directly at the camera

Facial Enrollment Procedure:Face the camera directly and follow voice instructions.Facial Enrollment Procedure:Duplicate face: "Existing face profile detected.Timeout: Process cancelled - no face detected.

2 Delete User

Please enter user
Voice Prompt:Enter registered user number (01-99) followed by # key.System Responses:Success: "User [XX] deleted successfully".Error: "Operation failed" (invalid number/00 attempted)Protection: Admin account cannot be deleted (if 00 entered)

3 System Settings

1 Time Setting, 2 Volume Adjustment, 3 Verification Mode, 4 Language Setting

After hearing the voice prompt, you can select the corresponding menu for configuration as needed

1 Time Setting

Please follow the voice prompt to enter the two-digit year, two-digit month, and two-digit day. Then, follow the voice instruction to enter the two-digit hour and two-digit minute.

2 Volume Adjustment

1 Volume up, 2 Volume down

3 Verification Settings

Single Authentication, Dual Authentication
Please follow voice prompts to select your preferred unlocking method, Single Authentication Unlock with one credential (fingerprint/card/code)", Dual Authentication Requires two different credentials (e.g. fingerprint + card)

4 Language Setting
1 Chinese, 2 English

6 Factory Reset

Initializing... ... Initialization complete.
Press # key to confirm selection. Follow voice prompts to finalize setup.Device entering factory mode. Configure new credentials immediately.

Accessibility Feature Guide

Restore to factory mode :
Use a pin to press and hold the 'Configuration Key' for approximately 6 seconds until the voice prompt announces 'Initializing, initialization successful.' Then release and wait for a moment to restore the device to factory settings.Note: No authentication key will be required to unlock the device at this stage. Please reconfigure the device promptly.

Freeze Mode:

After 5 consecutive failed authentication attempts, the system will enter "Freeze Mode." During this state, the "outdoor unit unit" will reject all commands and announce via voice prompt: "System frozen. Please try again later. The system will automatically resume normal operation after 3 minutes of inactivity in Freeze Mode.

Kmuun APP Configuration Instructions

!! • The networking features related to Kmuun DCS are currently being configured. Soon, you will be able to download the official "Kmuun" app from major app stores to complete the network setup with your device.

- Kmuun DCS uses 2.4 GHz Wi-Fi for network connectivity.
- The remote peephole function requires a strong Wi-Fi signal to ensure smooth video playback.
- Through the app, you can access features such as remote peephole, doorbell notifications, and Event Log Push Notifications.

Attention

- Before using this product, please read and understand all instructions. Damage caused by failure to comply with the instructions is not covered under warranty.
- It is recommended to use manufacturer-specified accessories or parts.
- Do not forcibly disassemble the product, as this may cause damage.
- Do not expose the product to leaking or splashing water.
- Do not clean the fingerprint scanner with sharp objects or corrosive liquids (such as banana oil , gasoline, or 84 disinfectant), as this may damage the sensor.
- Maintain the cleanliness of the product to prevent surface corrosion or damage.
- Use a soft cloth dampened with clean water to wipe the product, then dry the surface immediately.
- After installing the door lock, configure the lock settings as soon as possible to avoid security risks.
- Do not share the administrator password with others.
- If an access card is lost, it is recommended to reset the product to factory settings and reconfigure the key information.

Warranty Information:

- This product's after-sales service strictly complies with the Consumer Rights and Interests Protection Law of the People's Republic of China and the Product Quality Law of the People's Republic of China, offering a Three-Pack Guarantee (Repair, Replacement, Refund) as follows:
- Warranty Period:1year from the day after receipt of the product.If the product exhibits any malfunction listed in the Product Performance Failure Table, Kangmu Service Center will provide free repair services upon confirmation of the defect.
- Non-Warranty Cases:amage caused by human factors (misuse, accidents, unauthorized modifications, etc.).Out-of-warranty repairs are still available at Kmuun Service Center, but fees may apply based on the actual condition of the product.