

Kmuun Alpha

Intelligent entry system
user manual

v 0.9.4

Indoor unit



Width:460

Height:68

Thickness:36.5 (mm)

- Large-sized HD Display
- Emergency door opening via knob
- Touch for Camera

Outdoor



Width:460

Height:68

Thickness:36.5 (mm)

- Infrared Motion Detection
- Dual-Stage Hidden Keyhole
- Dual-Lens Facial Recognition

Material & Finish

Anodized Aluminum Alloy

Tempered Glass

Installation

Matched indoor and outdoor units
horizontal embedded design

Storage

100 keys

Keyboard

6 to 10-passcode

20-digit pseudo passcode

Zone Smart Backlighting

RFID Card Induction

Fingerprint

Resolution:500DPI

FRR:≤0.15%

FAR:≤0.00004%

Auto-update

Facial recognition

Distance: 30 - 120 cm

Height: 1 - 2.2 m

FRR: < 0.01%

FRR: < 0.00001%

Speed: < 350 ms

Peephole

Night Vision with LED Fill Light

Wide-Angle Camera

1280 x 720 Resolution

Voltage

12-24 V DC

7.4V Battery

Operating Environment:

RH(Non-cond): 20 % ~ 93 %

Temp: -10 °C ~ 55 °C

Voice Guidance

Chinese

English

APP

Kmuun APP



Video intercom

Remote unlock

Event Log

Alerts

Access Sharing

In The Box

- Indoor Unit
- Outdoor Unit
- Cables
- RFID Cards
- Pin
- User Manual

Firmware

Alpha-0330-092

1

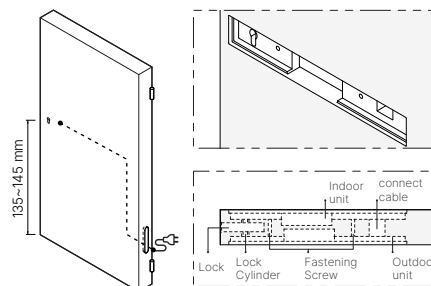

For the best face recognition, Kmuun Alpha should be installed at a height of 135-145mm from the ground to the keyhole. After choosing the right position for the keyhole, you need to make suitable holes and slots based on your door and lock. You can scan the QR code to get the detailed technical drawings to help with installation.

2

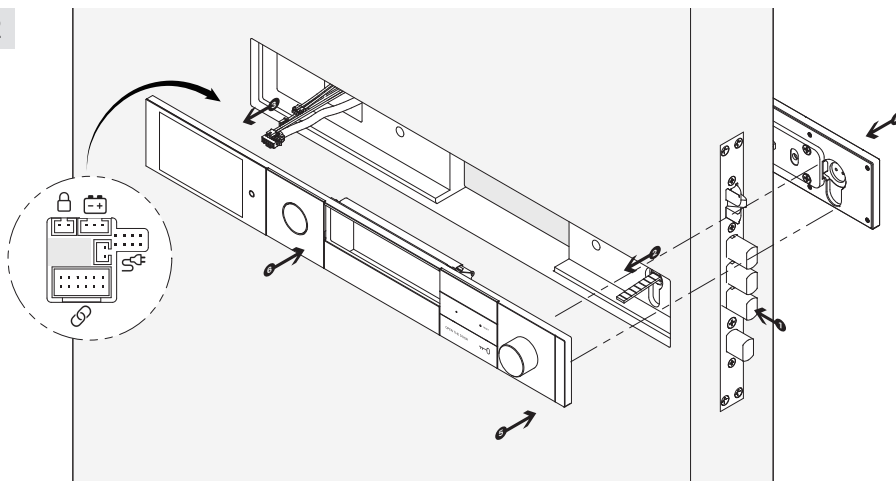

1 Install the auto-lock on the door. connect its power and control cables as required.

2 Insert the lock cylinder, then cut the spindle to the right length based on how thick the door is.

3 Connect everything as pictures: link the inside and outside parts, connect the keyhole to the lock, and finally plug in the power.

12 PIN Unit Connection Cable

3 PIN 7.4V Battery(optional)

2 PIN 12-24V 1A DC (power cable)

2 PIN Lock Control Cable

4 Install the outdoor unit into the slot on the door.

5 Place the indoor unit into the slot on the door, and ensure the spindle is attached to the knob's connector (see picture below).

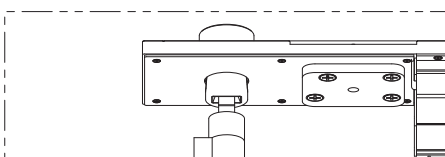

6 Choose two M4 flat screws that are the correct length for how thick your door is, then remove the 2 magnetic covers on the inside part, and finally use a screwdriver to attach the indoor and outdoor units together.

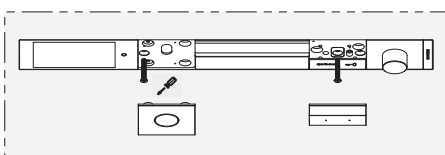

7 Installation Complete

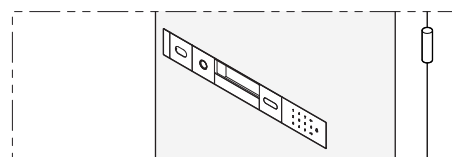

- Connect all wiring without power.
- Follow diagrams precisely.
- After installation, power on. If malfunction occurs, power off and recheck connections. If issues persist, contact technical support.

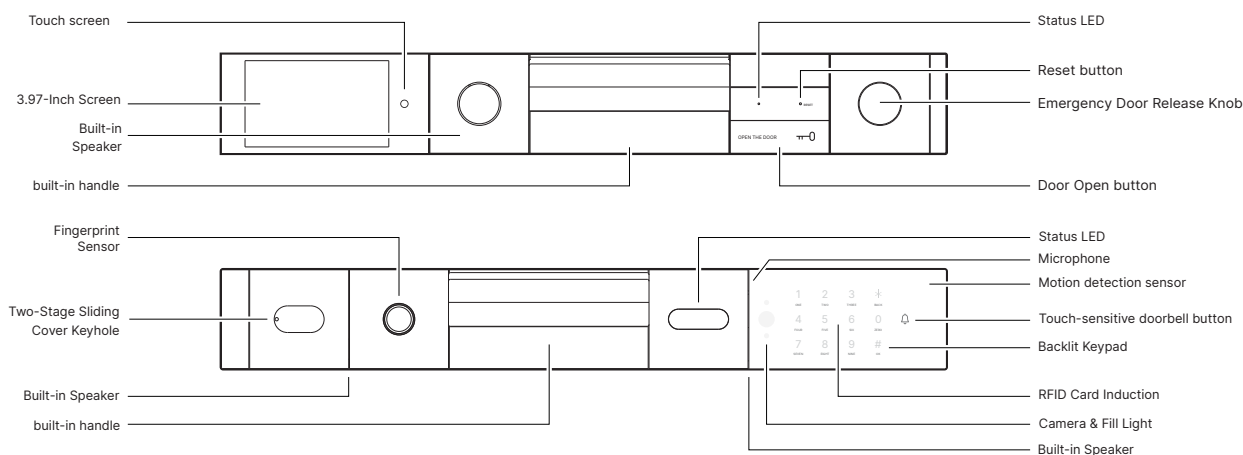

Local Features Operation Instructions

To enter the menu, short-press the 'Reset' on the indoor unit with a pin or press the "(* Key, (#) Key" on the outdoor unit. In factory mode, this menu is directly accessible. Otherwise administrator verification is required. The voice will announce 6 options, but the device only supports the following 4 options.

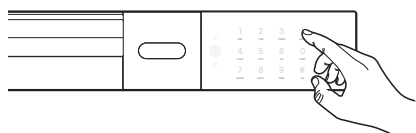
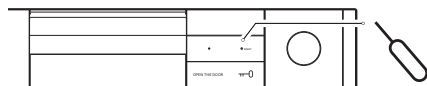

- 1 Create New User
- 2 Delete User
- 3 System Setting
- 6 Factory Reset

1 Create New User

Operation success, User 00

In initial setup mode (factory mode), the system will enter administrator configuration. You can sign up to 10 administrator

Enter user ID

After the voice prompt, enter a new or existing user ID (00-99), then press # to confirm. 00 = administrator | 01-99 = standard user.

- user ## enter access key
- 1 sign up fingerprint, passcode, RFID
- 2 sign up facial recognition
- 1 sign up fingerprint, passcode, RFID card

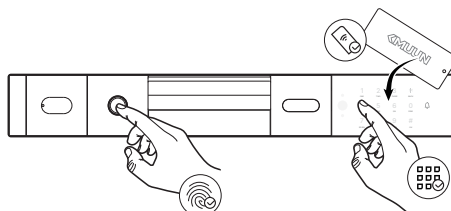

Fingerprint Enrollment: Place the finger on the outdoor unit fingerprint sensor. Follow the voice prompt "Please press again" and repeat several times until "operation successful" is announced. Interruption or incorrect presses may cause failure.

Passcode Setup: Enter a 6-10 digit passcode on the keypad. Re-enter it as prompted. If "operation success" is heard, the passcode is set. Passcodes with invalid length or mismatched entries will be rejected. Repeated passcodes are not allowed.

Access Card Registration: Hold the card close to the keypad area. A voice prompt "operation success" confirms registration. Duplicate cards will be rejected.

- 2 Sign up facial recognition

: Look directly at the camera

Face Registration: Look directly at the camera and follow the voice instructions. "operation successful" confirms registration.

Duplicate faces will be prompted. Process times out if delayed. Optimal range: 50 cm.

2 Delete user ID

Enter user ID

After the voice prompt, enter a configured user ID (01-99) and press #. If "Operation successful" is announced, the user is deleted. Incorrect IDs will result in failure. User 00 (administrator) cannot be deleted.

3 System Setting

1 Time Setting 2 set volume 3 Verification Mode 4 set language

Select a menu to configure after the voice prompt.

1 Time Setting

Follow voice prompts to enter the date (YYMMDD) and time (HHMM). Incorrect settings may disable temporary passcode function.

2 Volume Settings

1 Volume Up 2 Volume Down

3 Verification Settings

Dual Verification | Single Verification

Follow the voice prompt to select a method. Single verification requires one credential. Dual verification requires two different credentials.

4 Language Settings

1 Chinese 2 English

6 Factory Reset

Initializing... Initialization successful.

Press # to confirm. After the voice prompt, initialization is complete. The device will enter factory mode. Configure new credentials promptly.

Auxiliary Functions

Factory Reset

Hold the reset button with a pin for 6s until "Initializing ... Success" is heard. Release and wait. Unlock will require no credentials. Reconfigure immediately.

Lockout Mode

Triggered after 5 failed attempts. The external unit locks and announces "System locked. Try again later." Automatically resumes after 3 minutes.

Kmuun App Setup Guide

- Download the official "Kmuun" app from major APP stores to complete the device network setup.
- Kmuun α uses 2.4 GHz Wi-Fi for network connectivity. A stable Wi-Fi signal is required for the remote peephole function to ensure smooth video streaming.
- Through the APP, you can access features such as remote peephole viewing, doorbell notifications, and event log updates.

Notes

- Before use, read all instructions carefully. Damages from non-compliance are not covered by warranty.
- Use only manufacturer-specified accessories and parts.
- Avoid forcefully disassembling to prevent damage.
- Keep away from water or splashing environments.
- Do not clean the fingerprint sensor with sharp objects or corrosive liquids.
- Clean with a soft cloth and water to prevent surface damage.
- Set up the device immediately after installation to avoid safety issues.
- Keep the admin password confidential.
- If the RFID card is lost, reset the device and set up new keys.

Warranty

- This product's after-sales service strictly follows the "Consumer Protection Law of the People's Republic of China" and the "Product Quality Law of the People's Republic of China," with the following after-sales service terms:
- Within one year from the day after you receive the product, if any performance failure listed in the "Product Performance Fault List" occurs, the product will be repaired free of charge based on the warranty type after being inspected and confirmed by the KMUUN Service Center.
- For damages not covered by the warranty or caused by human factors, the KMUUN Service Center can still provide repair support, but a repair fee will be charged according to the actual condition of the product.