

Kmuun P3+

Intelligence Entry System User Manual

v 1.0.0

Indoor Unit



Width: 32
Height: 74
Depth: 13 (mm)

- Slim and Elegant Device
- Door Release Button
- Touch for Camera

Outdoor Unit



Width: 60
Height: 124
Depth: 17 (mm)

- Bilingual Voice Guide
- Immersive Panel Design
- Dynamic Indicator Light

Material & Finish

- Anodized Aluminum Alloy
- Tempered Glass
- ABS

Keyboard

- 6 to 8-passcode
- 20-digit pseudo passcode
- RFID Card Induction

Microwave radar sensor

- Independent in/out control
- Sensing distance: 2 ~ 3 m
- Relay connection duration: 30 s

Operating Enviroment

- RH: 40 % ~ 90 %
- Temp: -20 °C ~ 55 °C

In The Box

- Indoor Unit
- Outdoor Unit
- Accessories
- RFID Cards
- Pin & User Manual

Installation

- Ultra-thin embedded dual install

Fingerprint

- Fingerprint verification speed: <1S
- FRR: <1%
- FAR: 1/100000
- Resolution: 508DPI
- Auto-update

Power

- 12 ~ 24 V DC

Wireless technology

- Bluetooth 4.2

Storage environment

- RH: 40 % ~ 60 %
- Temp: 15 °C ~ 25 °C

Voice Guidance

- Chinese
- English

Firmware

- P3Plus-A201-100

1

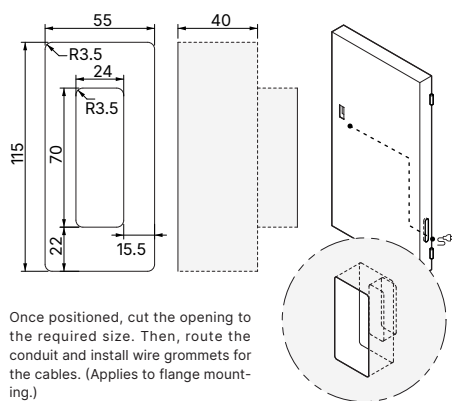

2

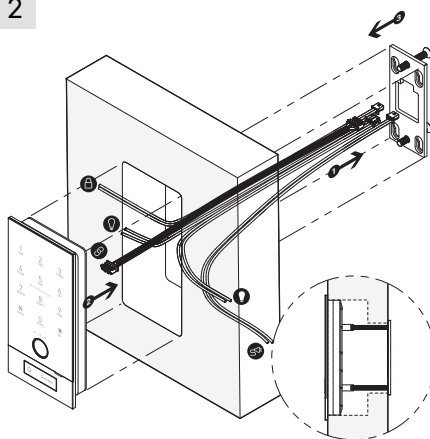

1

Connect the lock control cable and radar sensor to the lock and light, connect the power cable to the door's power supply, feed the end with connectors out through the slot for later use.

4

PIN Unit Connection Cable



3

PIN Microwave Radar Control Cable



2

PIN 12-24V DC Power Cable



2

PIN Dry Contacts Signal Lock Cable



2

Connect unit connection cable to outdoor unit and place into slot.

3

Select two M4 flat-head screws to match the door thickness. Secure the plate to the Outdoor unit as shown.

3

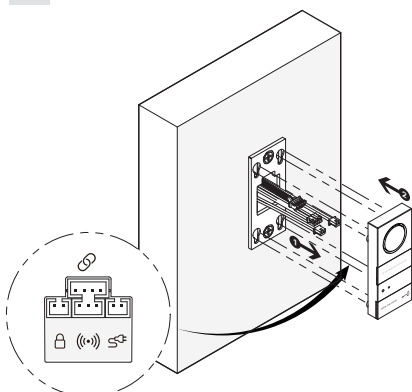

4

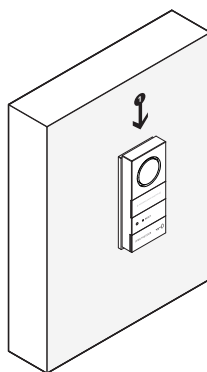

!

- Connect the product before turning on the power and strictly follow the wiring diagram to connect the product.
- After installation, power up the device. In case the product does not operate normally, immediately cut off the power and recheck the wiring.
- If the product still fails to function after rechecking, please contact a professional technician for technical support.
- For system operating on 12/24V DC, the combined power of all lights must NOT exceed 20/40 W.
- To install higher-power lights, it is advise to control the opening and closing of high-power lights by connecting to a separate power and relay.

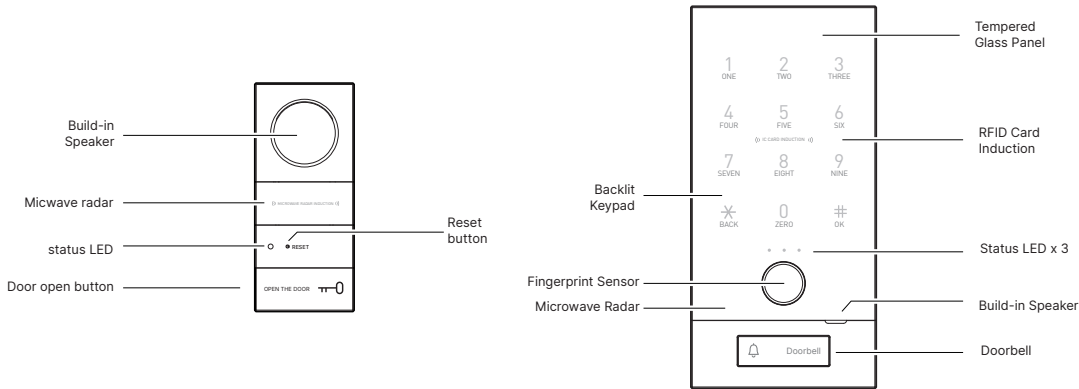

Local Features Operation Instructions

When you first power on the device, follow the prompts to select the system language. The device will then enter 'Setup Mode' automatically.

To enter the voice-guided configuration menu, short-press the 'Reset Button' on the indoor unit with a pin or press the "Star (*) Key + Hash (#) Key" on the outdoor unit. In factory mode, this menu is directly accessible. Otherwise administrator verification is required.

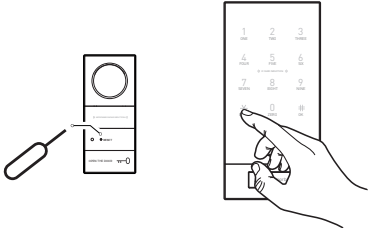

- 1 Add Admin
- 2 Add User
- 3 Add One-time Password
- 4 Delete Key
- 5 System Setting

1 / 2 Add Admin/User

Please Set Up (Admin) Fingerprint, Passcode, RFID Card.

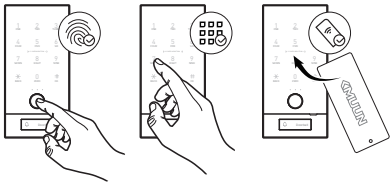

Fingerprint: Place your finger on the fingerprint sensor. Follow the voice prompt and repeat the process until you hear 'Key XXX, Setup succeeded.' Mistakes or interruptions may cause the setup to fail.

Passcode: Enter a 6 to 8-digit passcode on the keypad, and follow the voice prompt to enter it twice till it says 'Key XXX, Setup succeeded.' Inconsistent or too simple passwords will cause the setup to fail.

RFID Card: Place the card above the sensor. If you hear 'Key XXX, Setup succeeded,' the card is set.

Failure: Key capacity full, existing key, or non-compliant keys will cause the setup to fail.

3 Add One-time Passcode

Please Set Up One-time Passcode

Enter a 6 to 8-digit passcode on the keypad, and follow the voice prompt to enter it twice until you hear 'Key XXX, Setup succeeded.' This passcode is only for one-time use and cannot be set as the same one-time passcode or passcode.

4 Delete Key

1 Delete User by Key 2 Delete User by ID 3 Clear One-time Passcode 4 Clear User 5 Toggle Temporary Password Feature

Choose an option to delete. Entering an incorrect key ID or delete an unconfigured key will cause the failure. And you can not delete the last admin key. Turn on 'Temporary Password' to use 16-digit codes from the Kmuun app.

5 System Setting

1 Set Language 2 Set Volume 3 Set Lighting 4 Reset Factory Mode 5 Get Device Information

1 Set Language

English, 中文

2 Set Volume

1 Ringtone 2 Prompts 3 Toggle Keypad Sound

After press '1' or '2', feedback prompt sounds will be played. Repeat press until the appropriate feedback volume is reached to complete the setting. When disabled keypad sound, feedback from pressing the keypad will be indicated by backlight flash

3 Set Lighting

1 Toggle Indoor Auto Lighting 2 Toggle Outdoor Auto Lighting 3 Toggle Auto Keypad Backlight

Press '1' or '2' to toggle the indoor or outdoor auto lighting function.

The 'Keypad Auto Backlight' enables the keypad to light up when the proximity sensing is triggered.

4 Reset Factory Mode

Sure to reset Factory Mode?

After the voice prompt, press the HASH to confirm. Once you hear 'Factory Mode', the reset is complete.

5 Get Device Information

Version #####

Provide this information to the staff when troubleshooting or reporting issues with the device.

Accessibility Features

Force Reset to Factory Mode:

Use the pin to press and hold the 'Reset Button' for about 6 seconds until you hear 'Sure to reset Factory Mode?' Then release the button. After pressing the HASH, wait a moment for the device to reset to factory mode. Please note that no key is required to unlock under factory mode. Remember to setup the device promptly.

Frozen Mode:

After 6 times failures, the system will enter 'Frozen Mode.' During this time, the 'Outdoor Unit' will not accept any commands and will voice prompt 'System Frozen, Please try again later.' Device will automatically back to normal after 3 minutes of inactivity.

Status LED Infos

Mode	In	Out	Note
Factory	G ● ● ● ● ● ●	● ● ● ● ● ●	Slow Gradual
Frozen	R ● ● ● ● ● ●	● ● ● ● ● ●	Fast All Fast
Error	R ● ● ● ● ● ●	● ● ● ● ● ●	Static All Solid
Setup	Y ● ● ● ● ● ●	● ● ● ● ● ●	Slow Mid Slow
Pending Verif	Y ● ● ● ● ● ●	● ● ● ● ● ●	Fast Mid Fast
Syncing	G ● ● ● ● ● ●	● ● ● ● ● ●	Fast Cycling
Door Open	Y ● ● ● ● ● ●	2s	Solid On 2s
Fault	Y ● ● ● ● ● ●	x2	Solid Blinking X2
Reset Confirm	R ● ● ● ● ● ●	● ● ● ● ● ●	Slow All Slow
Unknown/Out	● ● ● ● ● ●	● ● ● ● ● ●	Off All Off

Notes

- Before use, read all instructions. Damages from non-compliance are not covered by the warranty.
- Use only manufacturer-specified accessories.
- Avoid forcefully disassembling to prevent damage.
- Keep away from water or splashing environments.
- Do not clean the fingerprint sensor with sharp objects or corrosive liquids.
- Maintain cleanliness to prevent surface damage.
- Clean with a soft cloth and water.
- Set up the device immediately after installation.
- Keep the admin password confidential.
- If the RFID card is lost, reset the device and set up new keys.

Warranty

- This product's after-sales service strictly follows the "Consumer Protection Law of the People's Republic of China" and the "Product Quality Law of the People's Republic of China," with the following after-sales service terms:
- Within one year from the day after you receive the product, if any performance failure listed in the "Product Performance Fault List" occurs, the product will be repaired free of charge based on the warranty type after being inspected and confirmed by the Kmuun Service Center.
- For damages not covered by the warranty or caused by human factors, the Kmuun Service Center can still provide repair support, but a repair fee will be charged according to the actual condition of the product.