

# Kmuun PSP

## Power Cable Pass-through User manual

v 0.9.0

### Door Leaf Unit



Width: 24  
Height: 288  
thickness: 45(mm)

### Door Frame Unit



Width: 24  
Height: 288  
Depth: 47.3(mm)

### Power Cable



#### Finish

- Anodized Aluminum Alloy
- PETG

#### Installation

- Mounting on the side of the door leaf & frame
- Wired Connection

#### Adapter Model

- DZ-H150S24-GPF-KM

#### Adapter Input

- AC 176 ~ 264V
- 50/60Hz  $\leq$  1A

#### Adapter Output

- Rated Voltage: DC 24V  $\pm$  6.25A
- Rated Voltage: 150W

#### Safety Standards

- IEC62368-1

#### Backup Battery

- Capacity: 2000mAh
- Voltage: 11.1V
- Standby Time: About 7 days

[Battery life applies only to normal operation of the lock and Kmuun device]

#### Environment

- RH(Non-cond): 20% ~ 90%RH
- Temp : -20 ~ 60°C
- Charging Temp: 0 ~ 40°C

#### Features

- Over-Voltage Protection (OVP)
- Battery Over-Charge Protection
- Battery Over-Discharge Protection
- Short-Circuit Protection (SCP)
- Over-Temperature Protection (OTP)
- Secondary Filtering

#### In the box

- Door Leaf Unit
- Door Frame Unit
- Power Cable
- Accessories
- Included cable

Firmware Version  
PSP-090



### Installation Diagram

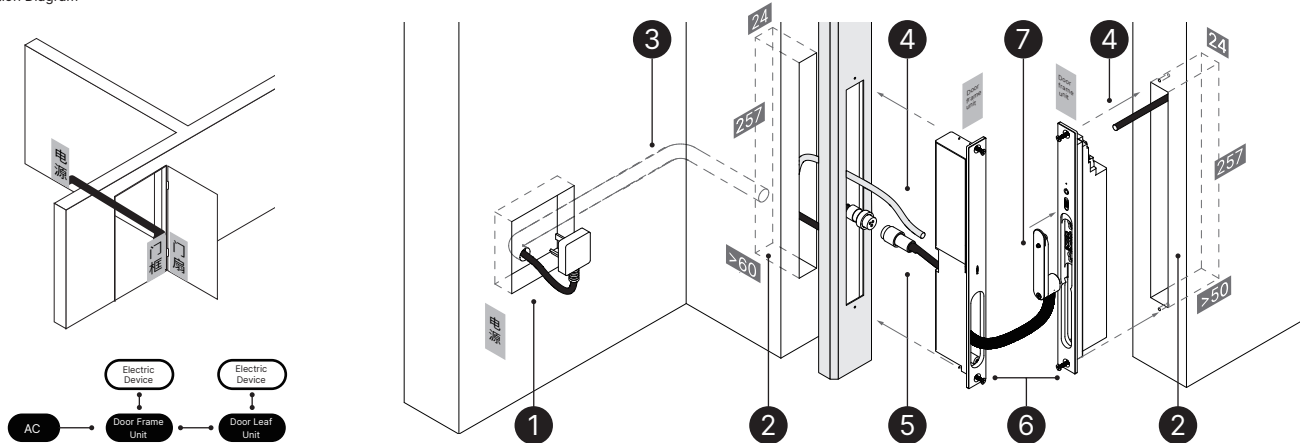

- Once the power source location is set, an outlet 86 box is installed on the wall. The conduit between electric source and door leaf unit is then run to the door, making it ready for the final wiring.

For safe operation, ensure the three-pin socket is properly grounded.

- Based on the PSP diagram & your product's actual requirements, cut openings/channels in the door frame, wall, and door leaf to accommodate the PSP device and allow extra space for cable routing.

- Pass the power cable through the pre-embedded conduit between the electric source and the door leaf unit, with the 3-pin plug positioned at electric source and the aviation plug at the door frame unit.

Power cable 3-pin plug to aviation plug

Do not remove the built-in three-pin plug yourself. Ask a professional to do it. Make sure the ground wire is properly connected.

- Connect the device cable and the automatic lock cable to the PSP door leaf unit. For other devices, use the ports as defined below.

#### Door leaf terminal

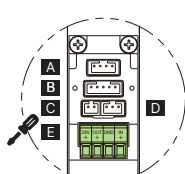

- A Input Port
- B Automatic Lock Power/Control
- C Signal Port
- D Control Circuit Input Port
- E Control Circuit Input Port

#### Door Frame Quick-Connect

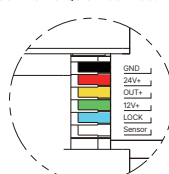

- GND Ground Port
- 24V+ 24V DC Output
- OUT+ Control Signal Output
- 12V+ 12V DC Output
- LOCK Lock Signal[Unlock High Level]
- SENS Connect to SENS on Port C of the door leaf

- With power off, connect the door frame aviation plug to the power cable's aviation plug securely.

- Place the door frame& leaf units into the slots, then secure them to the frame and leaf using the 4 included M4\*10 black self-tapping screws.

- Connect the door leaf & frame. Install the contact plate into the slot, slide it downward until it reaches the bottom, then tighten the fastening screws to complete the installation. Is ready for further testing.

[Click here to watch installation video](#)

Connect the product without power. Wire correctly per the diagram. After setup, power on. If malfunction occurs, disconnect power and check wiring. If unresolved, contact technical support.

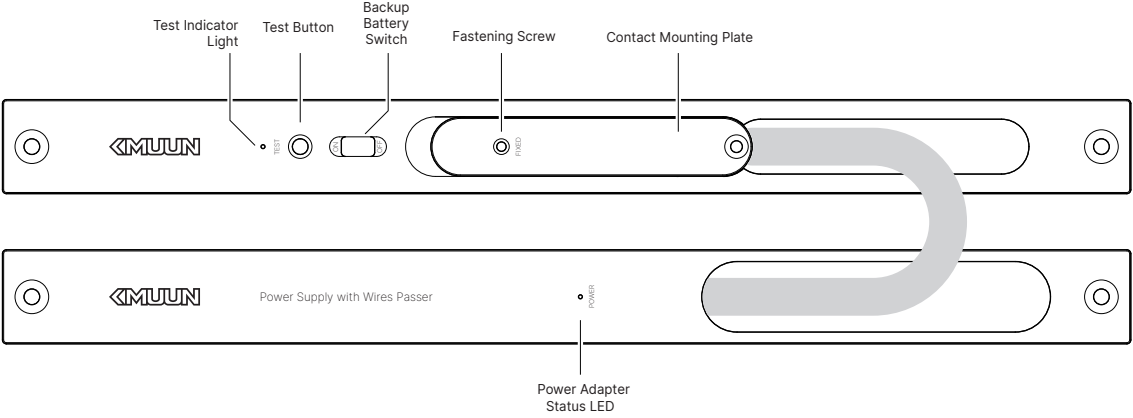

User Guide

Turn on/off Backup Battery

To prevent battery drain or accidental activation during transportation, turn the Backup Battery Switch OFF after testing. Switch it back ON only after installation at the user's home.

Troubleshooting

If a malfunction occurs during home visits, use the Test Button to diagnose: If the Test Indicator lights up but the lock doesn't respond → the lock is faulty. If the Kmuun device unlocks but the Test Indicator stays off → the Kmuun device has an issue. Contact support for assistance in either case.

Power Consumption Notes

Total power of all connected devices must not exceed 150W.

Total power of 12V devices must not exceed 30W.

Attention

- Before use, read all instructions carefully. Damages from non-compliance are not covered by warranty.
- Use only manufacturer-specified accessories and parts.
- Avoid forcefully disassembling to prevent damage.
- Keep away from water or splashing environments.
- Do not clean the fingerprint sensor with sharp objects or corrosive liquids.
- Clean with a soft cloth and water to prevent surface damage.
- Set up the device immediately after installation to avoid safety issues.
- Keep the admin password confidential.
- If the RFID card is lost, reset the device and set up new keys.

Warranty

- This product's after-sales service strictly follows the "Consumer Protection Law of the People's Republic of China" and the "Product Quality Law of the People's Republic of China," with the following after-sales service terms:
- Within one year from the day after you receive the product, if any performance failure listed in the "Product Performance Fault List" occurs, the product will be repaired free of charge based on the warranty type after being inspected and confirmed by the Kmuun Service Center.
- For damages not covered by the warranty or caused by human factors, the Kmuun Service Center can still provide repair support, but a repair fee will be charged according to the actual condition of the product.